

VIBRATION ISOLATOR

FLOOR MOUNTS

Type "T22" Single Deflection Rubber-In-Shear Isolator

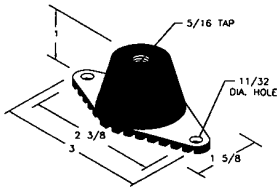

Model Number	Color Code	Rated Load	Rated Defl.	Price Each
T22	BLACK	40#	.25	\$7

Type "T44" Single Deflection Rubber-In-Shear Isolator

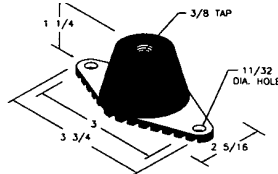

Model Number	Color Code	Rated Load	Rated Defl.	Price Each	
T44	3A	BLACK	100#	.25	\$8
	5A	BLUE	150#	.25	8
	7A	GREEN	300#	.25	8

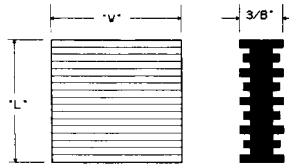

SERIES "NNP" RIBBED NEOPRENE ISOLATION PAD

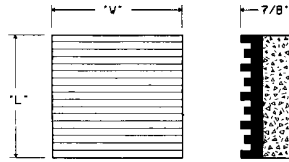

SERIES "CNP" COMBINATION CORK AND NEOPRENE ISOLATION PAD

Series "NNP" and "CNP" isolation pads have a recommended load rating of 50 lbs./sq. in. Minimum load is 25 lbs./sq.in. Maximum load is 70 lbs./sq. in.

Series "NNP" and "CNP" isolation pads are furnished with the ribs alternately raised and lowered to provide rated deflection over the rated load range.

Series "NNP" isolation pads have a deflection of .125"

Series "CNP" isolation pads have a deflection of .1875"

Model/Size	Price
NNP - 18" x 18"	\$65
NNP - 4" x 4"	5
CNP - 18" x 18"	94
CNP - 2" x 2"	2

HANGING ISOLATORS

Model HS-L and HS-I hangers with steel spring and neoprene noise isolation washer

Model HES-I hangers with steel spring and neoprene hanger element

Part Number	Rated Load Lbs	Spring Deflection	Dimensions In Inches					Price Each	
			L	W	H	F	A		B
HES-1-121	45-90	1.90"	3-1/2	2	9-1/4	4-5/8	1	3/4	\$48
HES-1-122	90-120	1.90"							
HES-1-123	120-175	1.90"							
HES-1-124	175-250	1.80"							
HES-1-125	250-330	1.80"							
HES-1-126	330-450	1.80"							
HES-1-127	450-600	1.70"							
HES-1-128	600-750	1.70"							

Part Number	Rated Load Lbs	Spring Deflection	Dimensions In Inches						Price Each
			L	W	H	F	A	B	
HSL-1-101	25-50	1.20"	2-3/4	2	4-1/2	3-1/8	7/8	5/8	\$18
HSL-1-102	50-100	1.20"							
HSL-1-103	100-150	1.20"							
HSL-1-104	150-250	1.10"							
HS-1-121	45-90	1.40"	3	2	7	4-5/8	1	3/4	\$26
HS-1-122	90-120	1.40"							
HS-1-123	120-175	1.40"							
HS-1-124	175-250	1.30"							
HS-1-125	250-330	1.30"							
HS-1-126	330-450	1.30"							
HS-1-127	450-600	1.20"							
HS-1-128	600-750	1.20"							

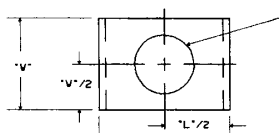

"A" Diameter Hole Top and Bottom for Maximum "B" Diameter Hanger Rod by Others

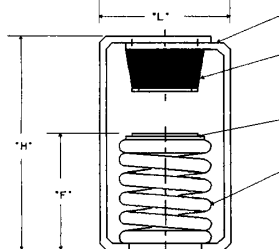

Heavy Duty Hanger Box
Double Deflection (1/2") Molded Neoprene Element
Steel Washer
Stable Steel Spring

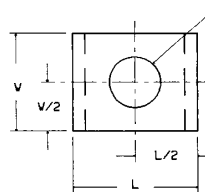

"A" Diameter Hole Top and Bottom for Maximum "B" Diameter Hanger Rod by Others

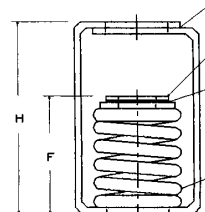

Heavy Duty Hanger Box
Steel Washer
Neoprene Isolation Washer
Stable Steel Spring

L. R. GORRELL COMPANY

PRICES SUBJECT TO CHANGE WITHOUT NOTICE! Minimum Order is \$25.00