



SPIRAL PIPE AND FITTINGS



Round and Ready Program

- Fabricated from G90 galvanized materials
- Meets Smacna 95' high pressure standards
- Materials shipped next day direct from Hamlin warehouse

SPIRAL PIPE

SIZE	PRICE
4" dia. 10'0" 26 ga	Call
6" dia. 10'0" 26 ga	Call
8" dia. 10'0" 26 ga	Call
10" dia. 10'0" 26 ga	Call
12" dia. 10'0" 26 ga	Call
14" dia. 10'0" 26 ga	Call
16" dia. 10'0" 24 ga	Call
18" dia. 10'0" 24 ga	Call
20" dia. 10'0" 24 ga	Call
22" dia. 10'0" 24 ga	Call
24" dia. 10'0" 24 ga	Call
26" dia. 10'0" 24 ga	Call
28" dia. 10'0" 22 ga	Call
30" dia. 10'0" 22 ga	Call

END PIECES

INSIDE PLUG EP

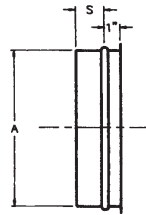

SIZE	PRICE
4"	Call
6"	Call
8"	Call
10"	Call
12"	Call
14"	Call
16"	Call
18"	Call
20"	Call
22"	Call
24"	Call
26"	Call
28"	Call
30"	Call

OUTSIDE CAP EC

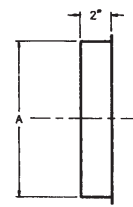

SIZE	PRICE
4"	Call
6"	Call
8"	Call
10"	Call
12"	Call
14"	Call
16"	Call
18"	Call
20"	Call
22"	Call
24"	Call
26"	Call
28"	Call
30"	Call

ELBOWS

DIE STAMPED 90° E-90-1

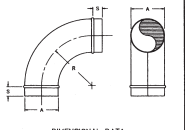

GORED ELBOW E-90-5, E-45-3

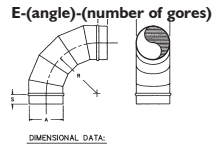

SIZE	PRICE
4" SE90	Call
6" SE90	Call
8" SE90	Call
10" E90-5	Call
12" E90-5	Call
14" E90-5	Call
16" E90-5	Call
18" E90-5	Call
20" E90-5	Call
22" E90-5	Call
24" E90-5	Call
26" E90-5	Call
28" E90-5	Call
30" E90-5	Call

SIZE	PRICE
4" SE45	Call
6" SE45	Call
8" SE45	Call
10" E45-3	Call
12" E45-3	Call
14" E45-3	Call
16" E45-3	Call
18" E45-3	Call
20" E45-3	Call
22" E45-3	Call
24" E45-3	Call
26" E45-3	Call
28" E45-3	Call
30" E45-3	Call

COUPLINGS

PIPE COUPLING

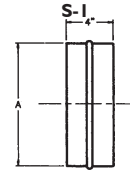

SIZE	PRICE
4" Internal	Call
6" Internal	Call
8" Internal	Call
10" Internal	Call
12" Internal	Call
14" Internal	Call
16" Internal	Call
18" Internal	Call
20" Internal	Call
22" Internal	Call
24" Internal	Call
26" Internal	Call
28" Internal	Call
30" Internal	Call

FITTING COUPLING

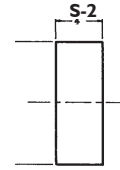

SIZE	PRICE
4" External	Call
6" External	Call
8" External	Call
10" External	Call
12" External	Call
14" External	Call
16" External	Call
18" External	Call
20" External	Call
22" External	Call
24" External	Call
26" External	Call
28" External	Call
30" External	Call



- Materials shipped FOB from Hamlin warehouse in Benson, NC.
- Freight cost added to order

L. R. GORRELL COMPANY

PRICES SUBJECT TO CHANGE WITHOUT NOTICE! Minimum Order is \$35.00



Round and Ready Program

- Fabricated from G90 galvanized materials
- Meets Smacna 95' high pressure standards
- Materials shipped next day direct from Hamlin warehouse

MINI BELLMOUTH

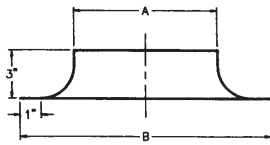

SIZE	PRICE
4" MR BM	Call
6" MR BM	Call
8" MR BM	Call
10" MR BM	Call
12" MR BM	Call
14" MR BM	Call
16" MR BM	Call
18" MR BM	Call
20" MR BM	Call
22" MR BM	Call
24" MR BM	Call
26" MR BM	Call
28" MR BM	Call
30" MR BM	Call

CONCENTRIC REDUCER

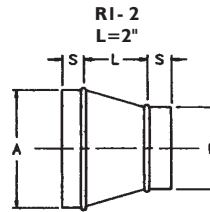

SIZE	PRICE
6x4 R1-2	Call
8x6 R1-2	Call
10x8 R1-2	Call
12x10 R1-2	Call
14x12 R1-2	Call
16x14 R1-2	Call
18x16 R1-2	Call
20x18 R1-2	Call
22x20 R1-2	Call
24x22 R1-2	Call
26x24 R1-2	Call
28x26 R1-2	Call
30x28 R1-2	Call



SIZE	PRICE
8x4 R1-4	Call
10x6 R1-4	Call
12x8 R1-4	Call
14x10 R1-4	Call
16x12 R1-4	Call
18x14 R1-4	Call
20x16 R1-4	Call
22x18 R1-4	Call
24x20 R1-4	Call
26x22 R1-4	Call
28x24 R1-4	Call
30x26 R1-4	Call

STRAIGHT SADDLE TAP TST

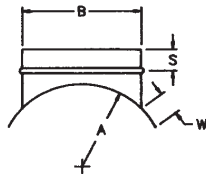

SIZE	PRICE	SIZE	PRICE
4" TST on Flat	Call	4" TST on 06"	Call
6" TST on Flat	Call	6" TST on 08"	Call
8" TST on Flat	Call	8" TST on 10"	Call
10" TST on Flat	Call	10" TST on 12"	Call
12" TST on Flat	Call	12" TST on 14"	Call
14" TST on Flat	Call	14" TST on 16"	Call
16" TST on Flat	Call	16" TST on 18"	Call
18" TST on Flat	Call	18" TST on 10"	Call
20" TST on Flat	Call	20" TST on 22"	Call
22" TST on Flat	Call	22" TST on 24"	Call
24" TST on Flat	Call	24" TST on 26"	Call
26" TST on Flat	Call	26" TST on 28"	Call
28" TST on Flat	Call	28" TST on 30"	Call
30" TST on Flat	Call		

STRAP & BRACKET

SIZE	PRICE
Bracket #BA3	Call
1" strap, galv., 250' roll	Call

ACCESS DOOR

SIZE	PRICE
8X4 on 06"	Call
8X4 on 08"	Call
8X4 on 10"	Call
8X4 on 12"	Call
8X4 on 14"	Call
8X4 on 16"	Call
12x8 on 18"	Call
12x8 on 20"	Call
16x12on22	Call
16x12on24	Call
16x12on26	Call
16x12on28	Call
16x12on30	Call

SEALER

SIZE	PRICE
ProSeal	Call



- Materials shipped FOB from Hamlin warehouse in Benson, NC.
- Freight cost added to order

LOUVERS & VOLUME CONTROL DAMPERS

ARROW UNITED EXTRUDED ALUMINUM LOUVERS

Model **EA-405** - 4" Deep, 450 Baffle Blade - Stationary - Flanged

Size	Price
12 x 12	\$79
18 x 18	124
24 x 12	110
24 x 24	169
30 x 16	183
36 x 24	199
36 x 36	298
48 x 48	459

SPECIFICATIONS	
MATERIAL:	Extruded aluminum, 6063-T52 alloy, available in .081" thick.
FACE OF LOUVER:	Full jam section, with blades, head and sill contained in jamb.
SCREENS:	Birdscreen - 1/2" flattened expanded aluminum .051". On Rear.
FLANGE:	Front flange may be field removed.
FINISH:	Mill Aluminum.

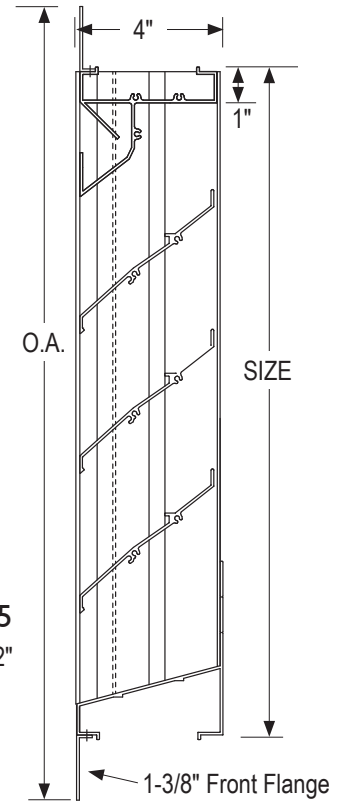

EA-405

O.A. = Louver Size + 2-1/2"

ARROW UNITED VOLUME CONTROL DAMPERS

Model **I770** - Galvanized Steel Control Damper

Size	Blade Arrangement	Price Each
12 x 6	Single	\$59
12 x 12	Opposed	69
16 x 14	Opposed	79
18 x 12	Opposed	79
18 x 18	Opposed	89
24 x 12	Opposed	89
24 x 18	Opposed	95
24 x 24	Opposed	122
30 x 24	Opposed	130
30 x 30	Opposed	152
36 x 24	Opposed	142
36 x 36	Opposed	198

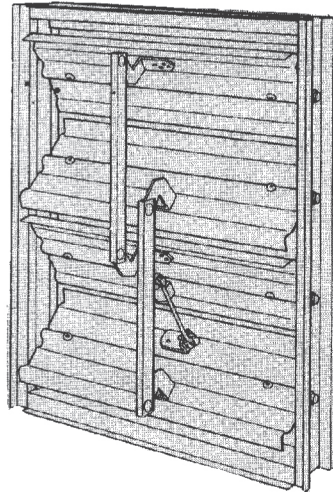

ARROW BRICK VENTS

Model **BV, BV FL**

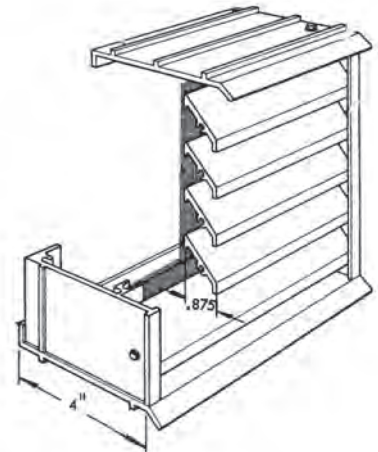

ACTUATORS

Model	Damper Size Range	Description	Price Each
235-115	12" x 06" - 24" x 12"	115 Volt Actuator*	\$94
ML-4115B	12" x 18" - 36" x 36"	115 Volt Actuator*	270
Q-37	ALL	Locking Quadrant	11

Model	Size (opening)	Price Each
BV	15 7/8" x 06" - 7 3/4"	\$68
BV FL Flanged	16 1/2" x - 7 3/4"	74

Notes:

- 1) 115V actuators are 2-position, spring return
- 2) ML-4115B is CCW power open, normally closed with Arrow I770 Damper. Accepts 1/2 sq. or 1/2 rd. shaft.
- 3) 235-115 is N.O. or N.C. based on motor installation

SPIN-INS AND ROUND BALANCING DAMPERS

COMMERCIAL METAL GASKETED SPIN-IN COLLARS

Model **SOS3** – Gasketed "Airtite" Style Take-Off w/Locking Quadrant on 1 1/2" Standoff.

Size	Diameter	Length	Price Each
6"	5 7/8" O.D.	6"	\$11
8"	7 7/8" O.D.	8"	13
10"	9 7/8" O.D.	8"	14
12"	11 7/8" O.D.	12"	16
14"	13 7/8" O.D.	12"	20
16"	15 7/8" O.D.	12"	22



TECHNICAL DATA
Galvanized Steel
Locking Quadrant Operator on Standoff
1 1/2" Wide Flange
Double Stick Neoprene Gasket

COMMERCIAL ROUND BALANCING DAMPER

Model **RBD** – 7 1/2 " Long Body

Size	Diameter	Price Each
6"	5 7/8" O.D.	\$24
8"	7 7/8" O.D.	26
10"	9 7/8" O.D.	28
12"	11 7/8" O.D.	30



TECHNICAL DATA
20 Gauge Galvanized Steel
Heavy Duty Metal Quadrant
1 1/2" Stand Off Bracket
Die Cast Metal Slide Pin & Control Rod
Bronze Bushings

SQUARE TO ROUND AND ROUND TO ROUND TRANSITIONS

SQUARE TO ROUND TRANSITIONS

Model **SRT**

Sizes In Inches	Price Each
6 x 6 x 6	\$5
8 x 8 x 6	6
8 x 8 x 7	6
8 x 8 x 8	6
9 x 9 x 7	7
9 x 9 x 8	7
9 x 9 x 9	7
10 x 10 x 8	7
10 x 10 x 9	7
10 x 10 x 10	7
12 x 12 x 10	8
12 x 12 x 12	8
15 x 15 x 12	10
15 x 15 x 14	10
18 x 18 x 16	12
20 x 20 x 14	14
20 x 20 x 16	14
20 x 20 x 18	14
22 x 22 x 12	16
22 x 22 x 16	16
22 x 22 x 18	16
22 x 22 x BLANK	16

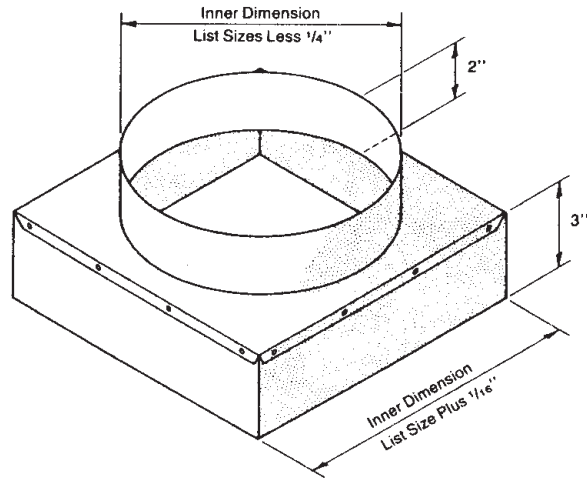

TECHNICAL DATA:
 Round Neck Sized 1/8" Under
 Square Neck Sized 1/4" Over
 Made of 28 gauge Galvanized Steel

ROUND TO ROUND REDUCERS

Model **RRT**

Sizes In Inches	Price Each
6" to 5"	\$4
8" to 6"	5
10" to 8"	6
12" to 8"	7
12" to 10"	7
14" to 12"	9
16" to 14"	11



TECHNICAL DATA:
 Inner Round Neck Sized 1/8" Under
 Outer Neck Sized 1/8" Under
 Made of 28 gauge Galvanized Steel

Concentric Round Reducers and Bellmouth Take-Offs may be found on page 31.

FLEXIBLE DUCT/CLAMPS, AND TIE STRAPS

FLEXIBLE DUCT

Type F216

- Positive 10" W.G.
- 25 - foot lengths
- R Value = 6.0

Diameter	Price Each
06"	\$36
08"	40
10"	54
12"	64
14"	74
16"	84

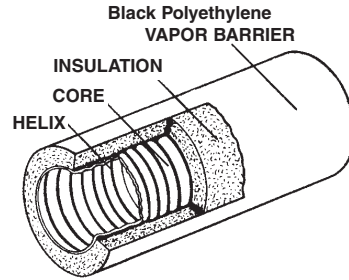

**** 10-Year Warranty****

Type F216 is a UL 181 Class I Air Duct which meets the requirements of NFPA 90A and 90B. Factory installed with fiber, it has a durable, scuff resistant polyethylene jacket. A continuous full internal core using an encapsulated wire, which helix completely shields the air flow from fiberglass erosion.

The F216 series is designed for use in low-to-medium pressures in HVAC systems.

The 25-foot lengths are shipped compressed for easy handling.

HEAVY-DUTY ADJUSTABLE CLAMPS

- An approved installation method for certain types of flexible duct under UL 181 standards of installation.
- 100% Nylon Clamps adjustable from 2" to 10" in diameter.
- For neck sizes larger than 12", combine two straps

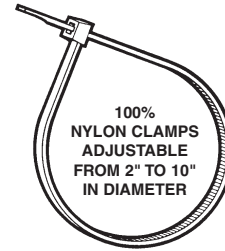

Model	Price Each
Tyton Clamp - 36" Long	\$ 0.36
Tyton T150 Tool	86.00

TOOLS - Model T150

- Fast tensioning
- Excess clamp material is trimmed with cutter
- Competitively priced
- Made in America

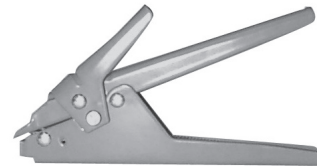

VIBRATION ISOLATOR

FLOOR MOUNTS

Type "T22" Single Deflection Rubber-In-Shear Isolator

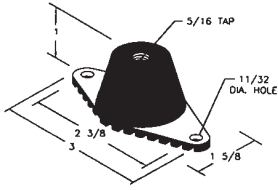

Model Number	Color Code	Rated Load	Rated Defl.	Price Each
T22	BLACK	40#	.25	\$8

Type "T44" Single Deflection Rubber-In-Shear Isolator

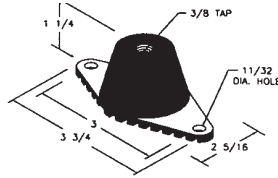

Model Number	Color Code	Rated Load	Rated Defl.	Price Each	
T44	3A	BLACK	100#	.25	\$10
	5A	BLUE	150#	.25	10
	7A	GREEN	300#	.25	10

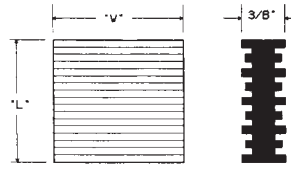

SERIES "NNP" RIBBED NEOPRENE ISOLATION PAD

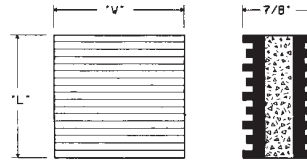

SERIES "CNP" COMBINATION CORK AND NEOPRENE ISOLATION PAD

Series "NNP" and "CNP" isolation pads have a recommended load rating of 50 lbs./sq. in. Minimum load is 25 lbs./sq.in. Maximum load is 70 lbs./sq. in.

Series "NNP" and "CNP" isolation pads are furnished with the ribs alternately raised and lowered to provide rated deflection over the rated load range.

Series "NNP" isolation pads have a deflection of .125"

Series "CNP" isolation pads have a deflection of .1875".

Model/Size	Price
NNP - 18" x 18"	\$91
NNP - 4" x 4"	8
CNP - 18" x 18"	134
CNP - 2" x 2"	5

HANGING ISOLATORS

Model HS-L and HS-I hangers with steel spring and neoprene noise isolation washer

Model HES-I hangers with steel spring and neoprene hanger element

Part Number	Rated Load Lbs	Spring Deflection	Dimensions In Inches						Price Each	
			L	W	H	F	A	B		
HES-1-121	45-90	1.90"	3-1/2	2	9-1/4	4-5/8	1	3/4	\$58	
HES-1-122	90-120	1.90"								
HES-1-123	120-175	1.90"								
HES-1-124	175-250	1.80"								
HES-1-125	250-330	1.80"								
HES-1-126	330-450	1.80"								
HES-1-127	450-600	1.70"								\$59
HES-1-128	600-750	1.70"								

Part Number	Rated Load Lbs	Spring Deflection	Dimensions In Inches						Price Each
			L	W	H	F	A	B	
HSL-1-101	25-50	1.20"	2-3/4	2	4-1/2	3-1/8	7/8	5/8	\$22
HSL-1-102	50-100	1.20"							
HSL-1-103	100-150	1.20"							
HSL-1-104	150-250	1.10"							
HS-1-121	45-90	1.40"	3	2	7	4-5/8	1	3/4	\$31
HS-1-122	90-120	1.40"							
HS-1-123	120-175	1.40"							
HS-1-124	175-250	1.30"							
HS-1-125	250-330	1.30"							
HS-1-126	330-450	1.30"							
HS-1-127	450-600	1.20"							
HS-1-128	600-750	1.20"							

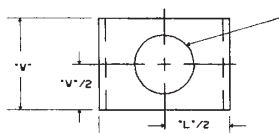

"A" Diameter Hole Top and Bottom for Maximum "B" Diameter Hanger Rod by Others

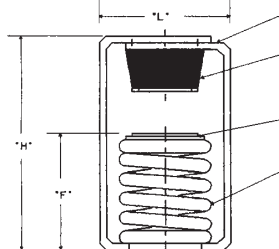

Heavy Duty Hanger Box
Double Deflection (1/2") Molded Neoprene Element
Steel Washer
Stable Steel Spring

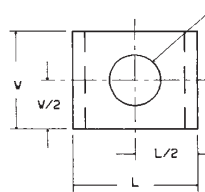

"A" Diameter Hole Top and Bottom for Maximum "B" Diameter Hanger Rod by Others

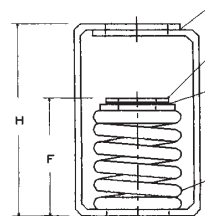

Heavy Duty Hanger Box
Steel Washer
Neoprene Isolation Washer
Stable Steel Spring

L. R. GORRELL COMPANY

PRICES SUBJECT TO CHANGE WITHOUT NOTICE! Minimum Order is \$35.00